

**Standard Sectional Assembly Drawing of High System Pressure Pump – Optional Silicon Carbide**

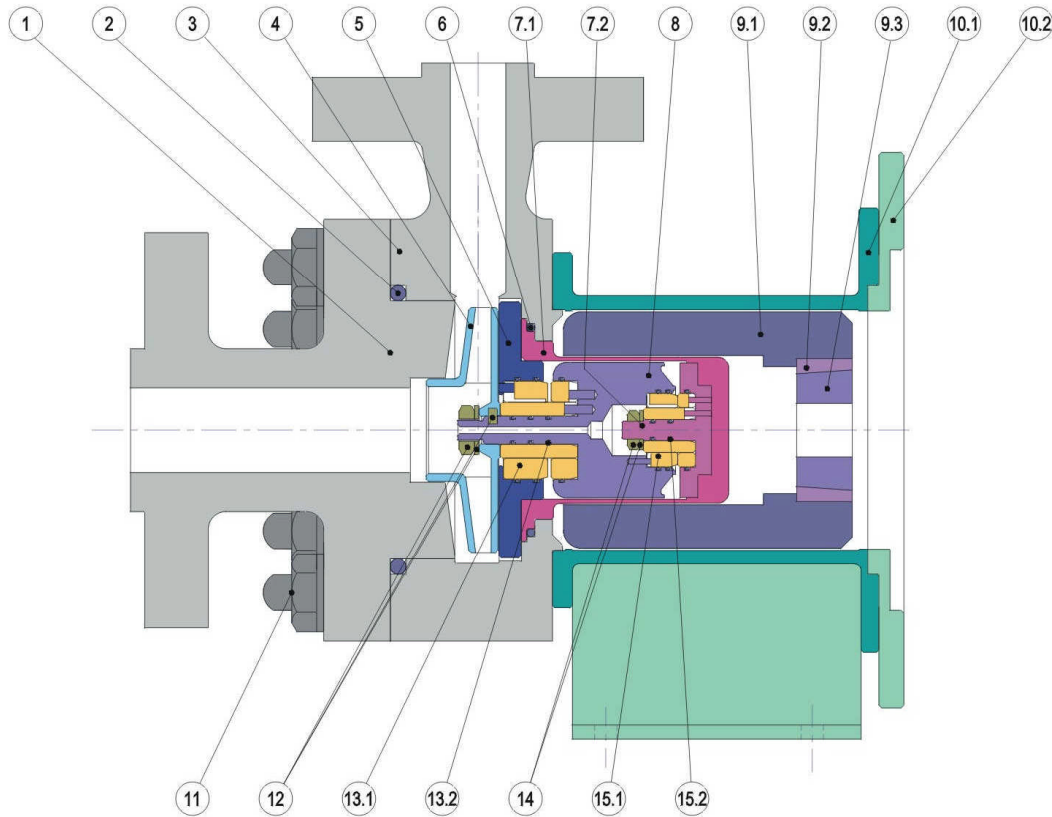

REF.	DESCRIPTION	QTY
1	FRONT COVER	One
2	CASING JOINT	(1-OFF *S1) (2-OFF *S2)
3	CASING	One
4	IMPELLER	(*S3)
5	BEARING HOLDER	(*S3)
6	CONTAINMENT TUBE O-RING	(1-OFF *S3) (1-OFF *S1)
7.1	CONTAINMENT TUBE ASSEMBLY	(*S2)
7.2	END CAP SPIGOT	(*S2)
8	PUMP SHAFT ASSEMBLY	(*S3)
9.1	OUTER ROTOR ASSEMBLY	One
9.2	OUTER ROTOR TAPER LOCK ADAPTOR	One
9.3	OUTER ROTOR TAPER LOCK BUSH	One
10.1	PEDESTAL	One
10.2	PEDESTAL ADAPTOR FLANGE (where required)	One
11	CASING STUD KIT	(*S3)
12	FRONT FASTENER KIT	(*S2)
13.1	FRONT BEARING ASSEMBLY	(*S2)
13.2	FRONT BEARING O-RING KIT	(*S2)
14	REAR FASTENER KIT	(*S2)
15.1	REAR BEARING ASSEMBLY	(*S2)
15.2	REAR BEARING O-RING KIT	(*S2)
RECOMMENDED SPARES		
*S1 COMMISSIONING SPARES		
*S2 2 YEARS OPERATIONAL SPARES		
*S3 HOLDING SPARES		